

For High Power Applications

- High Reliability through use of Tamura's Piezo Material Technology
- Thin Design
- Low Output Voltage warning terminal
- ON/OFF Terminal

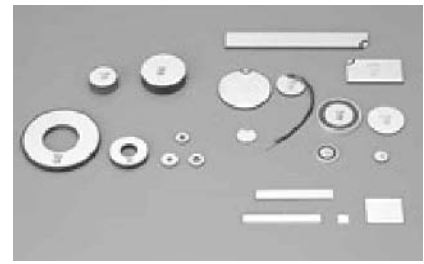

Contact Tamura for Custom Designs

Electrical Data

| Part # | Diameter (mm) | Thickness (mm) | Frequency1 (kHz) | kp(%) | Frequency2 (kHz) | kt(%) | Capacitance (pF) |
|--------|---------------|----------------|------------------|-------|------------------|-------|------------------|
| TDSE20 | 20.0 | 2.05 | 111.0 | 49 | 1010 | 45 | 1800 |
| TDSE25 | 25.0 | 2.05 | 87.5 | 49 | 1010 | 45 | 2800 |
| TDSE28 | 28.0 | 2.05 | 79.0 | 49 | 1010 | 45 | 3400 |
| TDSE40 | 40.7 | 2.05 | 54.0 | 60 | 1010 | 45 | 7100 |
| | 40.7 | 2.55 | 54.0 | 60 | 800 | 40 | 5600 |
| TDSE43 | 42.7 | 2.05 | 50.5 | 62 | 1010 | 45 | 7800 |
| | 42.7 | 11.2 | 50.5 | 68 | 200 | 31 | 1500 |
| TDSE70 | 71.5 | 20.5 | 31.0 | 62 | 1010 | 45 | 22000 |

Mechanical Dimensions

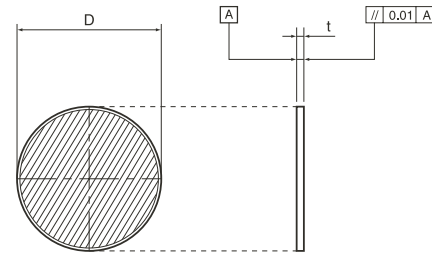

※ "t" means the thickness and "A" means the parallel tolerance of ceramic before silver electrode is printed.

| Part # | Outside Diameter (mm) | Inside Diameter (mm) | Thickness (mm) | Frequency (kHz) | Coupling Coefficient | Capacitance (pF) |
|----------|-----------------------|----------------------|----------------|-----------------|----------------------|------------------|
| TBLE1507 | 15.2 | 6.6 | 2.00 | 100 | 42 | 840 |
| TBLE3015 | 30.0 | 14.7 | 5.00 | 48 | 42 | 1300 |
| TBLE3515 | 35.0 | 14.7 | 5.30 | 44 | 42 | 1850 |
| TBLE5023 | 50.0 | 23.0 | 6.00 | 30 | 41 | 3000 |
| TBLE6030 | 60.0 | 30.0 | 6.30 | 25 | 42 | 3900 |
| TBLE7032 | 70.0 | 32.0 | 6.50 | 21.5 | 44 | 5400 |

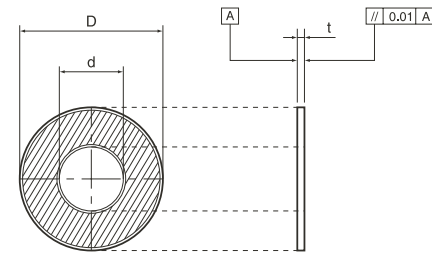

※ "t" means the thickness and "A" means the parallel tolerance of ceramic before silver electrode is printed.

| Part # | Length (mm) | Width (mm) | Thickness (mm) | Coupling | Frequency (kHz) | Capacitance (pF) |
|----------|-------------|------------|----------------|----------|-----------------|------------------|
| TPE17535 | 175.0 | 35.0 | 2.55 | 40 | 800 | 27.5 |
| TPE20025 | 200.0 | 25.0 | 2.55 | 40 | 800 | 22.5 |
| TPE8080 | 80.0 | 80.0 | 2.55 | 40 | 800 | 29.0 |

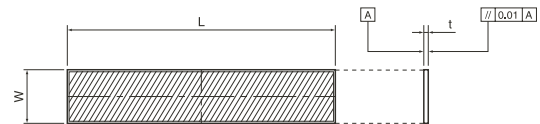

※ "t" means the thickness and "A" means the parallel tolerance of ceramic before silver electrode is printed.

TAMURA CORPORATION

43352 Business Park Drive. | P.O. Box 892230 Temecula, CA 92589-2230 | www.tamuracorp.com
 USA | Japan | United Kingdom | Hong Kong
 Tel: 800-872-6624 | Tel: 81 (0)3 3978-2111 | Tel: 44 (0) 1380 731 700 | Tel: 852-2389-4321
 Fax: 909-676-9482 | Fax: 81 (0)3 3923-0230 | Fax: 44 (0) 1380 731 702 | Fax: 852-2341-9689

Bolt-Clamped Langevin Transducers

For Pressure Sensor type applications

TAMURA's bolt-clamped langevin type (BLT) transducers are capable of generating stabilized ultrasonic waves against the fluctuations of temperature, input power and load fluctuation, using high strength and large amplitude piezoelectric ceramic material.



| Items | TBL4535D-28HB □ TBL4535D-28HN □ | TBL6035D-28HN □ | TBL4535D-40HB □ TBL4535D-40HN □ |
|--------------------------------------|---|-----------------|------------------------------------|
| Dimensions(mm) Specifications | | | |
| Resonance frequency (kHz) | 28 | | 40 |
| Resonance impedance (Ω) | below 30 | | below 40 |
| Static capacitance (pF) | 3500 or 3800 | | |
| Allowable input power (W) | 70(Using one BLT only) / 50(Using two BLT's and more) | | |
| Allowable operating temperature (°C) | below 120 | | |

※ In case with the bolts, groove processing is not provided.

TAMURA CORPORATION

| |
|--|
| 43352 Business Park Drive. P.O. Box 892230 Temecula, CA 92589-2230 www.tamuracorp.com |
| USA Japan United Kingdom Hong Kong |
| Tel: 800-872-6624 Tel: 81 (0)3 3978-2111 Tel: 44 (0) 1380 731 700 Tel: 852-2389-4321 |
| Fax: 909-676-9482 Fax: 81 (0)3 3923-0230 Fax: 44 (0) 1380 731 702 Fax: 852-2341-9689 |